



## TECHNICAL DESCRIPTION

Number of modules	8
Type of modules	StandardLine
Dimensions of modules	10,000x2,990x3,438 mm
Area	240 m2
Internal height	3,010 mm
Length of manufacture	2 weeks
Length of assembly	2 weeks
Windows	Plastic frames, double glazing, with external roll-up screens
External doors	MZ
Interior - walls	Gypsum boards with wallpaper and painting, ceramic tiles in bathrooms, sanitary partitions
Interior - floors	Tiles
Facade	PUR panel with microwave
Heating	Hot water heating
Fire resistance	-
Equipment	Suspended ceiling from acoustic cassettes, porch with a stainless steel frame and safety glass

## Description

Cleanness and simplicity of installation is obvious in the annex building of the social facility for personnel of SCHMIDT GmbH, a German company using the KOMA system. It was built to serve as changing rooms and a rest area. The KOMA system demonstrates its usability for extension while maintaining the original building features. So freshness and simplicity of installation in this case

## Schmidt Social Facility

Site location	Töllen Linde 3, Delbrück, Německo
Implementation date	09/2011
Price	EUR 120,000 (excl. VAT)
The price includes	Supply of upper building. The price does not include: Preliminary construction work, heating and secondary PUR facade

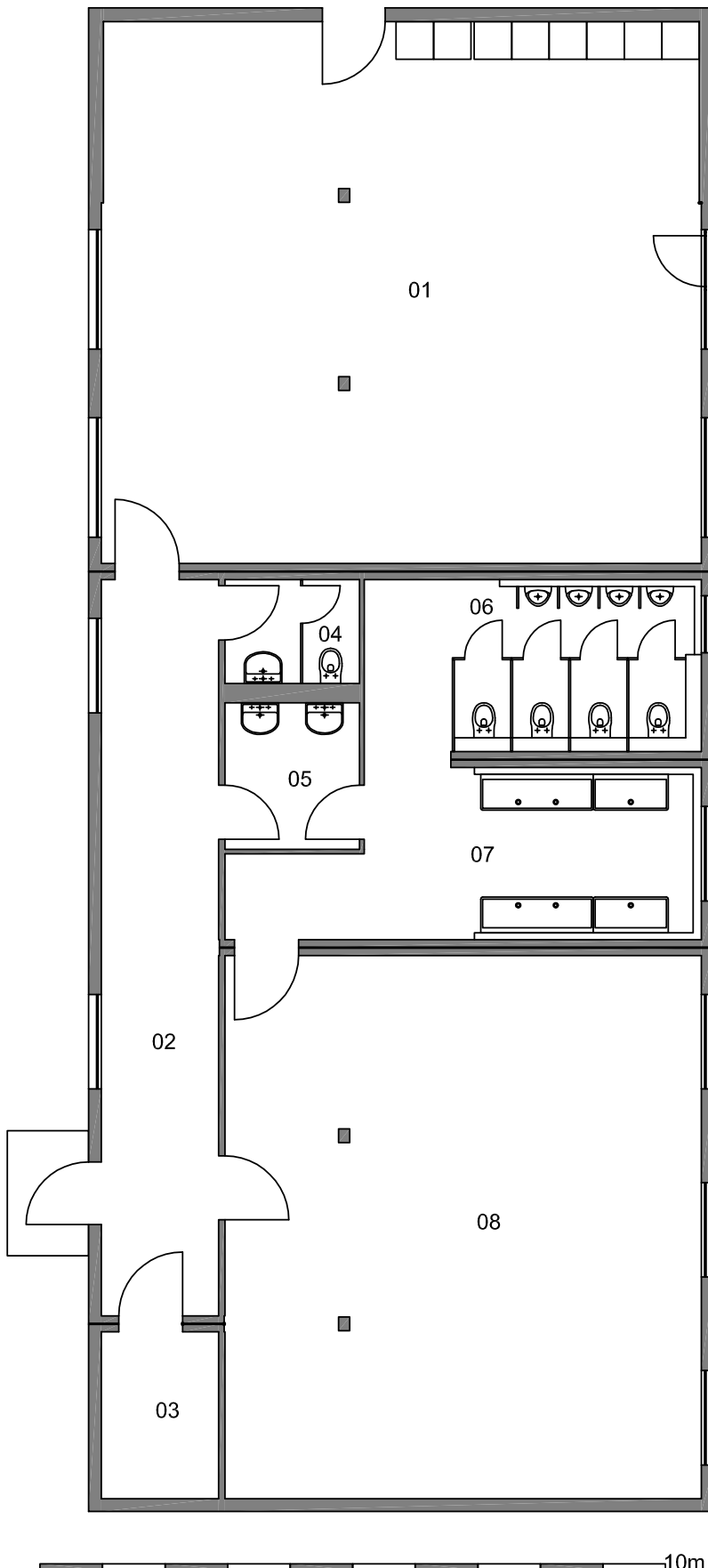

LEGEND

01	DINING ROOM + KITCHEN
02	HALL
03	UTILITY ROOM
04	TOILET
05	WASHROOM
06	TOILET
07	WASHROOM
08	CHANGING ROOM

